

AVAILABLE > INDUSTRIAL BUILDING

# 6050 MANCHESTER TRAFFICWAY TERRACE

KANSAS CITY, MISSOURI



## PROPERTY HIGHLIGHTS

- > Total Building Area: 96,065± SF
- > Utilities:
  - > Electrical: 2MW transformer - 480V/3-phase
  - > Water: 8" municipal waterline
- > Loading:
  - > 12 dock-high doors
  - > 1 drive-in door
- > Clear Height: 19'-19'6"
- > Lighting: LED on motion sensors
- > Sprinklered: Wet
- > Floor Drains: Throughout building
- > Striped Parking: 52 spaces
- > Roof: All sections replaced in last 5 years
- > Land Area: 5.42 acres
- > Zoned: M1-5
- > Lease Rate: \$2.85 PSF, NNN

DOUG HEDRICK sior, ccim  
+1 816 556 1136  
KANSAS CITY, MO  
doug.hedrick@colliers.com

TOM KENNEDY  
+1 816 556 1118  
KANSAS CITY, MO  
tom.kennedy@colliers.com



AVAILABLE > INDUSTRIAL BUILDING

# 6050 MANCHESTER TRAFFICWAY TERRACE

KANSAS CITY, MISSOURI

## FLOOR PLAN

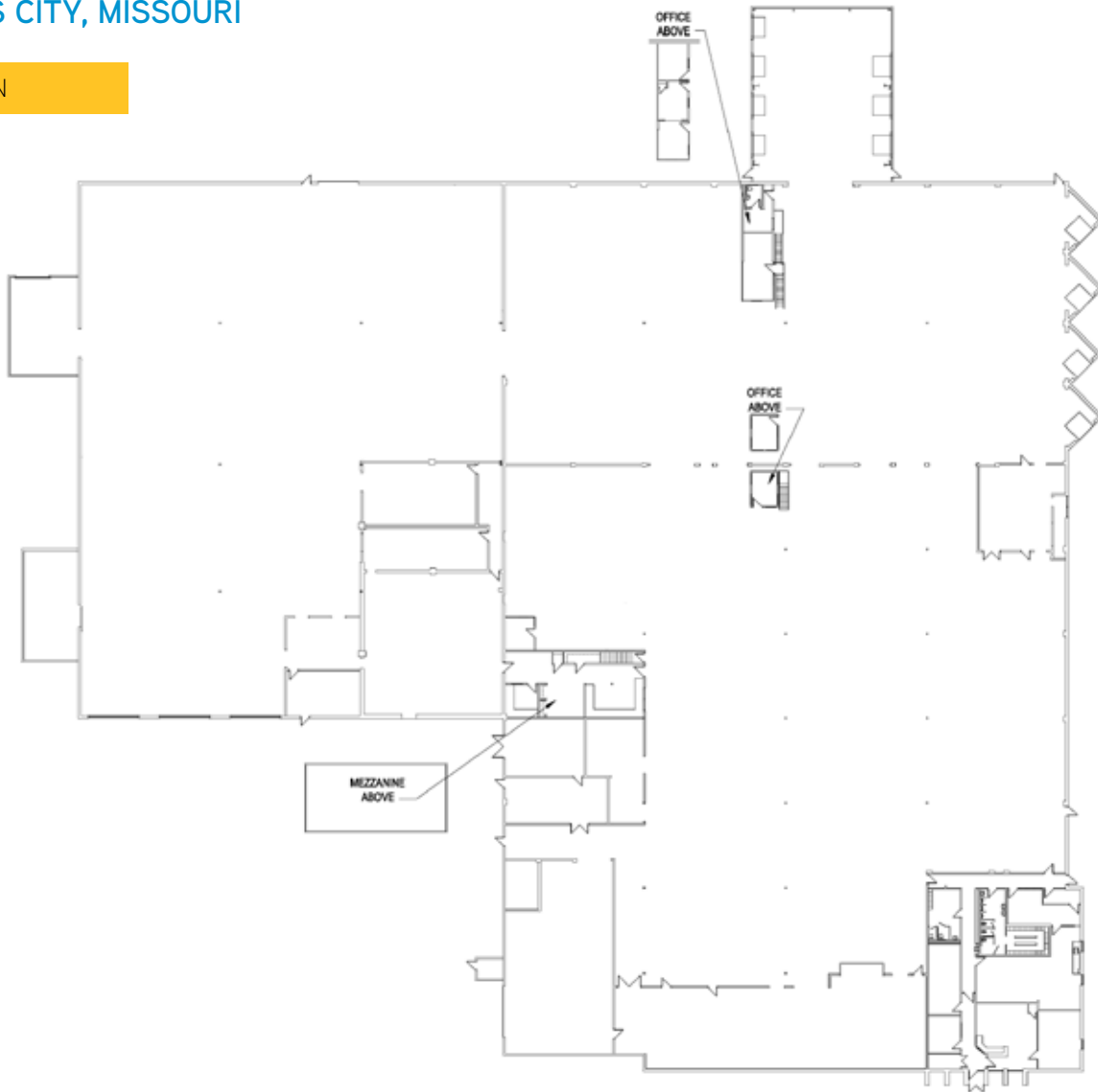

## LOCATION

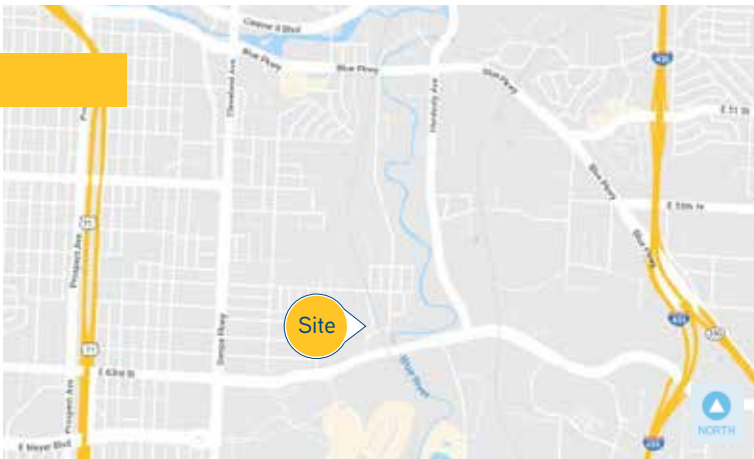

## CONTACT

DOUG HEDRICK SIOB, CCIM  
+1 816 556 1136  
KANSAS CITY, MO  
doug.hedrick@colliers.com

TOM KENNEDY  
+1 816 556 1118  
KANSAS CITY, MO  
tom.kennedy@colliers.com

This document has been prepared by Colliers International for advertising and general information only. Colliers International makes no guarantees, representations or warranties of any kind, expressed or implied, regarding the information including, but not limited to, warranties of content, accuracy and reliability. Any interested party should undertake their own inquiries as to the accuracy of the information. Colliers International excludes unequivocally all inferred or implied terms, conditions and warranties arising out of this document and excludes all liability for loss and damages arising there from. This publication is the copyrighted property of Colliers International and/or its licensor(s). ©2019. All rights reserved.

